

# Parkheath

*Sold on Service*

**Ashburnham Road NW10**

**£6,500 PCM (£1,500 per week) - Brent Band E**



Stunning family home, beautifully modernised and extended  
Superb kitchen/dining area with skylights and bi-fold doors to rear garden  
4 double bedrooms plus office/bedroom 5  
Blend of contemporary design and period features  
Conveniently situated near Kensal Rise & Kensal Green stations

Arranged over three floors, offering 2100 Sq Ft of accommodation  
27' reception room with library wall feature  
Luxury family bathroom and ensuite shower room  
Nestled in the heart of Kensal Rise, easy access to amenities  
EPC: Rating: D, Council Tax: Brent band E

Kensal Rise Office 0208 960 4845



Ashburnham Road, London, NW10

Approximate Gross Internal Area 195 sqm / 2100 sqft



Ground Floor

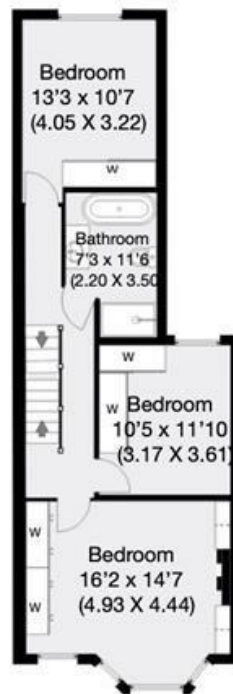

First Floor

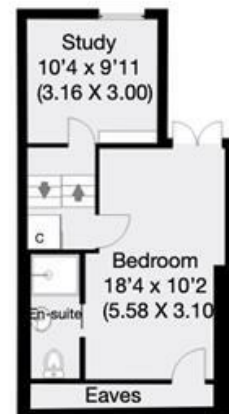

Second Floor

THIS FLOOR PLAN IS PRODUCED FOR PARKHEATH SUBMITTED BY ARCHIMEDIA web: [www.archi-media.co.uk](http://www.archi-media.co.uk)

Whilst every attempt has been made to ensure the accuracy of the floor plan contained here, measurements of doors, windows and rooms are approximate and no responsibility is taken for any error, omission or misstatement. These plans are for representation purposes only and should be used as such by any prospective buyer or lease. Specifically no guarantee is given on the gross internal floor area of the property if quoted on this plan and any figures given is initial guidance only and should be treated as such.

The particulars do not constitute part of an offer or contract. The particulars, including text, photographs and plans, are for the guidance only of prospective purchasers/tenants and must not be relied upon as statements of fact. The descriptions provided therein represent the opinion of the author and whilst given in good faith should not be construed as statements of fact. Nothing in these particulars shall be deemed a statement that the property is in good condition or otherwise or that any services or facilities are in good working order. All measurements are approximate